

Smart Toilet Installation Guide

Intelligent toilet manual precautions for use

Content

Before Using

Safety Instructions.....	01
Precautions for Use.....	05
Parts Identification.....	07

Toilet Installation

Installation Guidance.....	09
Installation Steps.....	10
Remote Control Installation.....	14
Trial Run.....	14

Instruction for Use

Side Control Panel Instruction.....	15
LED Display Screen Instruction.....	15
Remote Control Instruction.....	16
Usage Instruction.....	16
Automatic Sensing Function.....	18
Advanced Features.....	18





Appendix

Remote Control Battery Replacement.....	18
Foam Shield Instructions.....	19
Usage Instruction.....	20
Fault Judgement And Solutions.....	21
Daily Maintenance.....	23
Technical Support.....	24
List of Materials.....	25

Safety Instructions

Please read the safety instructions carefully before using.

The precautions listed here are important in relation to safety and should always be strictly observed.

The meaning of the diagram is as follows		Examples and descriptions of the Diagram	
 Caution	It means that if this sign is ignored and product handled improperly, the users will be dead or be injured seriously.	 It means prohibition. The left diagram indicates "Disassemble prohibited"	
 Note	It means that if this sign is ignored and product handled improperly, the users will be injured seriously or subject to property loss.	 It means that it must be observed. The left diagram indicates "strictly abide by"	

Caution



Do not spray water or detergent on the main body or electronic plug

No sprinkling

- May cause fire or electric shock.
- May cause breakage or damage to the toilet seat or water seepage in the room.

This product belongs to electronic products, please do not install the product in an easily splashed or humid place. Please install an exhaust fan and other exhaust equipment to ensure unobstructed air flow in the bathroom

- Otherwise, it may cause a fire or an electric shock.

Please set the socket for power wiring as follows

- If the wiring is not as follows, it may cause a fire or electric shock.

a. Please use high inductance, fast type leakage switch (rated induction current below 10mA) or protect with insulated transformer (above 1.5KVA, below 3KVA) for the circuit of socket.

b. The installation position of the socket must be more than 0.3m from the ground and as far away from the bathtub as possible.

The grounded wire equipped with the product must be grounded, please be sure to connect to the ground wire

- Otherwise, it may cause an electric shock.

Note: The grounding treatment mentioned here means that the grounding resistance is below 4Ω protective earthing, and the grounding wire uses copper wire of 1.6 mm or more in diameter.

When using in the bathroom

Please make sure power supply and the plug is sealed with silicone to prevent the water

- Otherwise, it may cause a fire or electric shock.

Caution



Do not use in humid places

Do not install this product in humid places such as Shower room. (Prevent water from entering electronic components)

- May cause a fire or electric shock.



Disassemble prohibited

Never disassemble or repair or modify by yourself

- May cause a fire or electric shock.



Prohibition

Malfunctioning products are forbidden to use

- Under the following circumstances, please unplug the power supply and close the water valve to stop supplying water.

Fault refers to:

- The main body or water pipe leaks water.
- The product is cracked or damaged.
- There is abnormal noise or peculiar smell.
- The product smokes and abnormally hot.
- Toilet blockage.

- Fault products are forbidden to use, otherwise, it may cause a fire or electric shock and even indoor water seepage, etc.



Prohibit the touch with wet hands

It is forbidden to plug or unplug the power supply with wet hands

- May cause an electric shock.



Prohibition

Do not damage the power cord and toilet connection line

It is forbidden to pull, modify, heat, twist, place heavy objects on the power cord and toilet connection line.

- Damaged products are forbidden to use, otherwise, it may cause a fire or electric shock or short circuit.



Prohibition

Do not use loose or shaking power outlets

- May cause a fire or electric shock.



Prohibition

Water except for tap water and potable water is forbidden to use

- May cause skin inflammation.



Prohibition

Do not use the multi-socket socket

- Please do not connect the wire or use the extension cord when using, it may lead to heat and cause a fire and electric shock.

Caution



Required

Attention to prevent low temperature burns

- Please adjust the seat temperature to normal level when sitting for a long time.
- Please adjust the seat temperature to the normal stage, the wind temperature to the low level, when the following people use "thermal seat" and "warm air drying" functions.

- Children, the elderly, and other users who cannot adjust the appropriate temperature by themselves.
- People with walking problems such as the sick and disabled.
- Sleepy people who took medicines, sleeping pills, cold medicines, etc., with sleepy side effects, drank too much, got overtired, etc.

Caution



No fire

Do not keep cigarettes and other burning stuff nearby

- May lead to a fire.



Prohibition

It is forbidden to put your fingers or sundries at the warm air outlet It is forbidden to touch the warm air outlet with hands or cover it with cloth

- May cause burns, electric shock, fire.
- Please be careful when children and the elderly using.



Prohibition

Do not apply force, stand on the seat ring, the flip lid or the main body, and heavy objects are forbidden placed on it

- May cause product to crack, the main body to fall apart, the person to be injured.
- Toilet may be damaged and indoor water seepage will occur.



Prohibition

Use diluted kitchen detergent (neutral) to clean. Avoid these products:

(toilet cleaner, detergent, petrol, banana water, cleaning powder and nylon brushes, etc.)

- May damage and crack the plastic, deforming and cracking it and causing personal injury.
- May damage water pipes and cause water leakage.



Prohibition

When opening the water inlet angle valve, do not remove, or rotate, open the water filter net

- May cause water leakage.



Prohibition

Do not bend or damage the water filter screen

- May cause water leakage.



Prohibition

Do not flush any sundries except excrement and toilet paper

- May cause the water closet to be blocked and the sewage will leak out of the room.



Required

Disconnect the power plug for a long time of not using.



Required

Close the water angle valve to stop supplying water when water leaking



Required

Prevent damage caused by freezing

- May cause damage to the water inlet configuration and the interior body, and leakage may occurs.



Required

Tighten the water filter net when installing

- Otherwise, it may cause water leakage.

Please implement warming, to raise the rest room temperature



Required

Make sure the power plug in

- Ensure the power plug is plugged in before using, and the plug and socket fit closely without looseness or incomplete insertion
- Otherwise, it may cause a fire due to heat.
- Disconnect the power plug for a long time of not using.



Required

When the toilet is blocked, unplug it and use a commercially available pipe unblocker to remove the blockage

- Otherwise, it may lead to sewage leakage and indoor water seepage when automatically cleaning.



Required

Do not install it in a place directly exposed to light

- May cause discoloration, aging, and deformation.

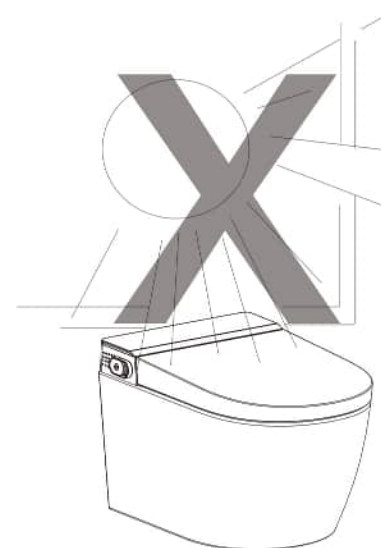

Precautions for Use

Cleaning Mistakes

Do not wipe the main body with hard and coarse cloth or tools to avoid scratching.



Avoid directly washing with water

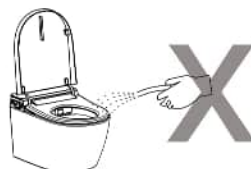

Daily Maintenance

Avoid splashing urine on the main body or spray nozzle.

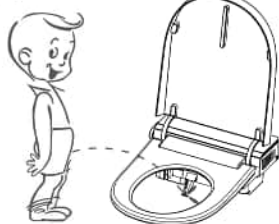

Pull out the power plug during the thunder storms.



Improper Operation

Shall not cover the seat sensor, human infrared sensor, and the transmitting signal and receiving signal of the remote control.

- May cause the smart toilet misoperation.

Keep away from the main body when using the radio, etc.

- The radio may be garbled

Do Not Lean Back On The Flip Lid

- May cause crack.

Put Away The Child's Seat Placed On The Seat After Using

- May cause some functions unavailable.

Precautions for Use

Take anti-freeze measures to prevent freezing damage during the freezing night in winter.

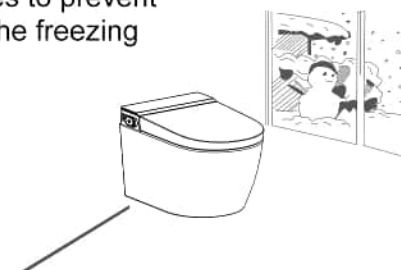

Do not put heaters near the main body.

- May cause discoloration or malfunction.

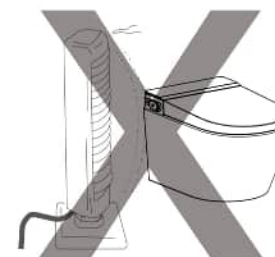

Do not roughly open the seat ring or flip lid

- May cause crack or malfunction.



Parts Identification

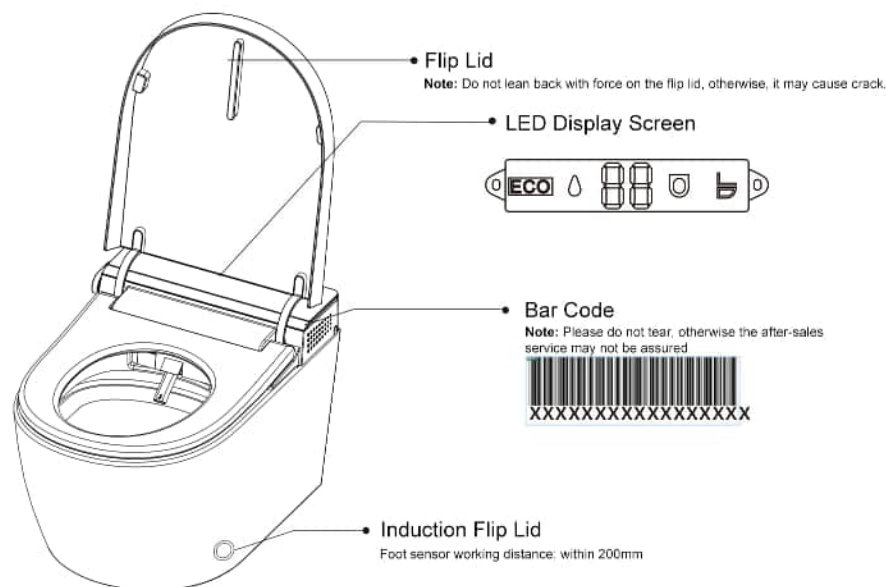
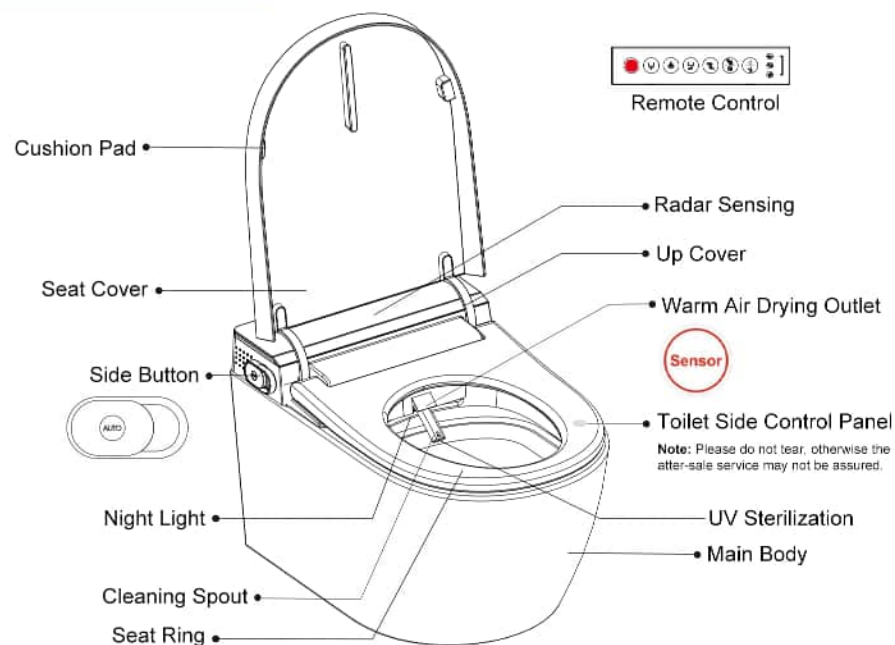

Main Functions

Female/Pulsate	Rear/Pulsate	Children/Pulsate
Water Pressure	Position	Flush
Water Temp	Wind Temp	Seat Temp
Hot/Cold	Hight/Low	Dryer

Humanized Functions

Self-clean	Light	Eco
UV Sterilization	Remote Control	Cover

Humanized Functions

Earth Leakage Prevention	Fireproof	Antibacterial
--------------------------	-----------	---------------

Installation Guidance

List of Materials

Screwdriver 

Wrench 

Marker 

Tape measure 

Glue gun 

Utility Knife 

Installation drawings

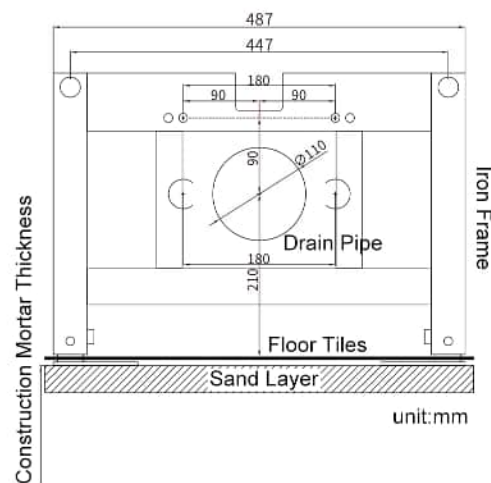
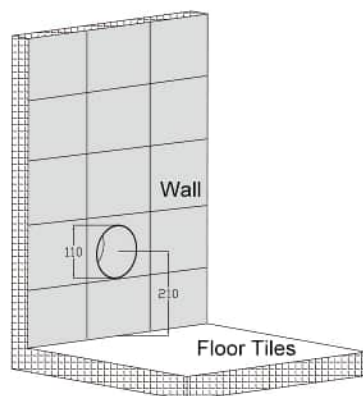

Size Drawings

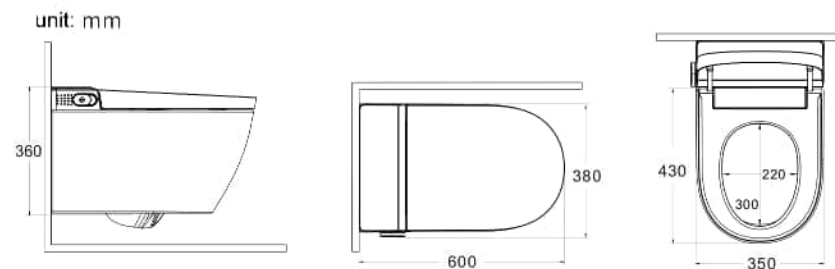

Installation Steps

1. Fix the toilet fixing frame on the wall according to the schematic diagram, and confirm the position of the water and electricity connection.

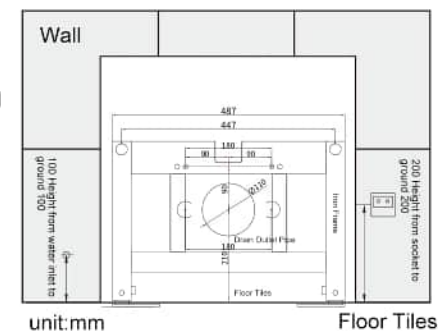

Iron Frame Installation



(1) Confirm the position of the iron frame, loosen the screws to adjust the height of the iron frame, and calibrate the horizontal distance and vertical distance using the spirit level.



(2) Install the fixed wall hooks and tighten the screws.



(3) Use a mark pen to mark the position of the expansion screws, remove the iron frame, and punch holes according to the mark.



(4) Move the iron frame back to its position, insert the expansion screws into the holes, and screw them tightly.



(5) Install the toilet fixing screws.



Caution

Please set the socket as follows

1. Ensure the socket properly grounded.
2. The power cord length is 1.4m and be located close to the socket, convenient to install and remove, and as far away from the bathtub as possible.
3. Use waterproof socket and don't use extension power cord to connect.
· May cause a fire or electric shock.

Installation Steps

2. Please check the height from the drain pipe and screw rod to the ground after installation.

Note: The above dimensions are for the finished surface after the floor tiles are installed.

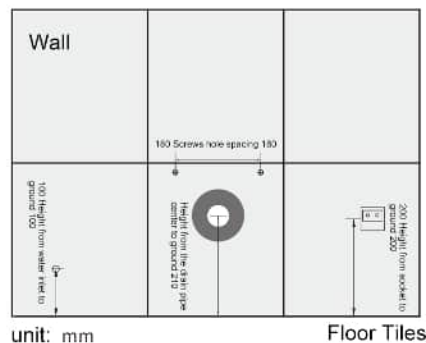

3. Unscrew the fixing screws of the smart top and separate it from the water tank and disassemble it from the main body.

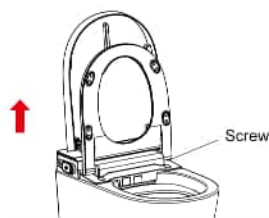

4. Tear off the back covering of the damping mat and paste it in the corresponding position on the back of the toilet.

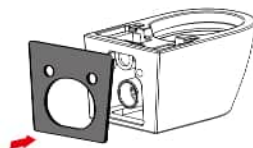

5. Fix the toilet in the correct position.

Note: Check the water inlet, plug, and drain pipe.

- (1) Align the drain pipe.
- (2) Align the fixing bolts.
- (3) Push the toilet hard.
- (4) Lock the fixing bolts.

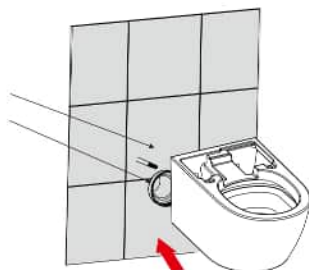

Installation Steps

6. Install plastic gaskets, metal gaskets, nuts, decorative covers, and other accessories in sequence.

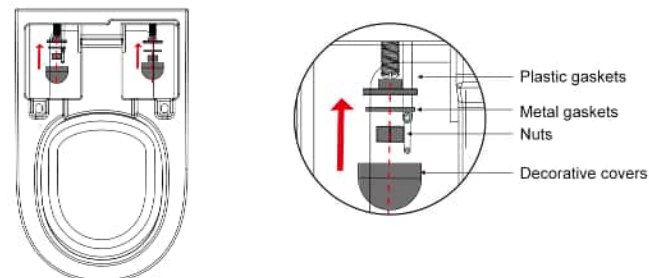

7. Make sure that the front, back, left, and right sides of the toilet are in a horizontal position.

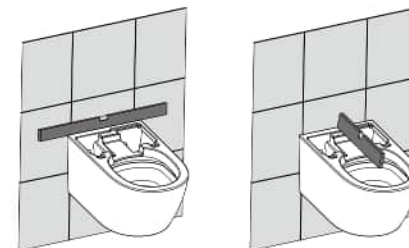

8. Connect the smart top to all the connecting wires of the toilet.

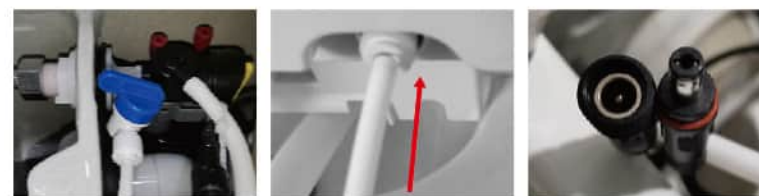

(1) Insert the pipe

(2) Insert the reducing valve pipe

(3) Water pump connection line



(4) Foot sensor connection line

(5) Insert the water splitter

(6) Battery cable (optional)

Installation Steps

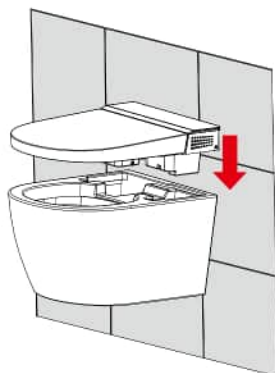

9. Confirm whether the connection cable is properly connected, and then fix it back to the ceramic.

- (1) Fix the smart top to the main body.
- (2) Make sure that the connecting wires between the toilet and smart top are well connected.
- (3) Screw on the fixing screws of smart top and main body.

10. Confirm that the toilet is fixed in good condition, and the installation is completed.



Note

1. Smart toilet accessories have been commissioned, personal disassembly is strictly prohibited. Please use the fittings and hoses provided by our company. Old fittings and hoses cannot be reused. If have any questions, please contact local retailers or our after-sales service department.

2. All contents of this instruction manual are based on the latest conditions at the time of printing. We reserve the right to make changes without further notice.

Remote Control Installation

Installation Method

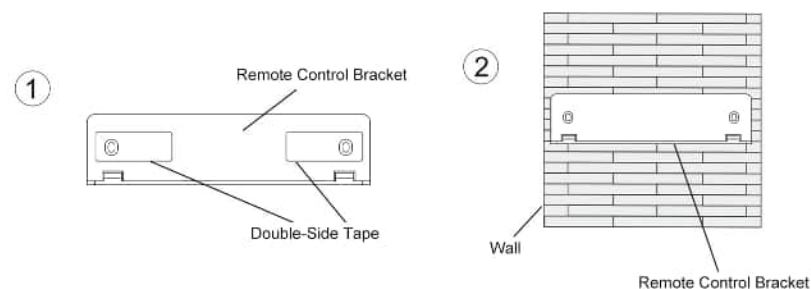

Note:

1. Clean the installation area before taping. Press the tape firmly and evenly when applying. Can be used after 15 minutes.
2. Double-side tape is suitable for tile-type flat walls, not for wallpaper-type walls.

Trial Run

1. Seating Sensor

The picture shown is the seating sensor area. Only when the system senses someone is seated, the function can be on. Then, the buzzer will "beep" once, indicating it has been sensed and the system can be activated. When the human body leaves the sensor place, the buzzer will also "beep" once.



2. Check Fundamental Functions

When the human body sits on the sensor, the buzzer beeps. Press the "Rear" or "Bidet" button on the side control panel to operate.



3. Check the Drying Function

When the human body sits on the sensor, the buzzer beeps. Press the "Drying" button on the side control panel to operate.



Side Control Panel Instruction

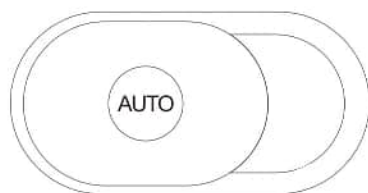

Clockwise: arm cleaning or reciprocating cleaning

Counterclockwise: feminine cleansing or reciprocating motion

Short press: stop or flush when leaving the seat, stop or dry when seated

Long press: power on or standby

LED Display Screen Instruction

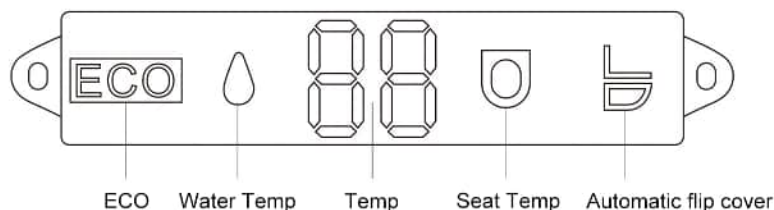

Remote Control Instruction

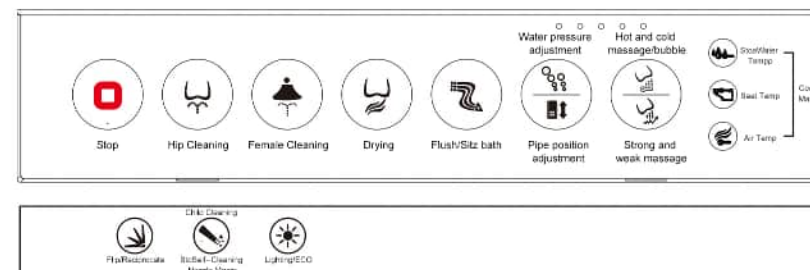

Remote control coding steps

Press the water temperature and air temperature at the same time until the 4 indicators flash. Power on the whole machine and complete the coding.

Note: If the code cannot be matched, please reinstall or replace the remote control battery with a new one, and then repeat the code matching operation.

Usage Instruction

Stop

Stop the current cleaning or drying function, press and hold to restore factory settings

Hip Cleaning

After sitting down, press to start the butt cleaning function, wash for 2 minutes and dry for 5 minutes

Female Cleaning

After sitting down, press to activate the feminine cleansing function, which will wash for 2 minutes and dry for 5 minutes.

Drying

After sitting down, press to start the drying function and dry for 5 minutes.

Flush/Sitz bath

Press to activate or deactivate the sitz bath function during buttock washing or feminine washing, and the sitz bath function lasts for 6 minutes. Press to activate the flushing function in other modes.

Water pressure adjustment

Water pressure adjustment gears, 5 gears in total

Usage Instruction

Pipe position adjustment

Pipe position adjustment gears, 5 gears in total

Hot and cold massage/Bubble

Press to turn on or off hot and cold/Bubble

Strong and weak massage

Press to activate or deactivate the strong or weak massage function

Water Temp

Press to adjust the water temperature, a total of 5 levels

Seat Temp

Press to adjust the seat temperature, a total of 5 levels

Air Temp

Press to adjust the air temperature, a total of 5 levels

Child Cleaning

After sitting down, press to start the child washing function, wash for 2 minutes and dry for 5 minutes.

Self--Cleaning Nozzle Mast

Long press to turn on seated automatic foam shield

Flip

After leaving the seat, press to open the seat cover and open and close the seat ring. Press and hold the ring cover position to remember the position.

Lighting

Press to activate or deactivate the lighting function. Press and hold to activate or deactivate the energy-saving function.

Foot sensing function

Foot sensor, when the ring cover is closed - open the cover, open the ring and close - open the ring; when both ring covers are open - close the ring. (In special circumstances, if the ring cover is opened for more than 10 seconds - close the ring cover and flush)

ECO

Energy-saving is turned on. When no one is seated, the seat temperature is 32 degrees. When someone is seated, it will automatically adjust to the set temperature.

Prevent low temperature burns

To prevent low-temperature burns, the temperature will automatically adjust to the lowest temperature of 34 degrees after 10 minutes of sitting down.

UV sterilization function

Sterilization function, with cleaning action, automatically starts sterilization for 2 minutes after closing the ring cover for 1 minute

Automatic Sensing Function

Seat cover/seat automatic opening and closing

Human body sensing, the lid will automatically open when a person approaches. If the signal of a person leaving is detected, the lid will be closed in 30 seconds. If no signal of a person leaving is detected, the lid will be closed after 2 minutes.



Microwave switch and gear adjustment

Long press the "Cover" button to switch Microwave on and off station

Remote Control Battery Replacement

When the battery runs out, the remote control maybe insensitive or out of control occasionally. Please replace the alkaline batteries immediately.



Note

The polarity of battery must be put in the right position and the compression spring extends from the negative pole.

- New and old batteries should not be mixed.
- Please use alkaline batteries.

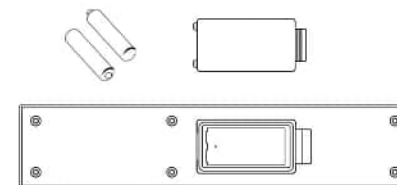

Note: Remote control with batteries. Please appropriately store it in a location that is out of reach of young children.

Foam Shield Instructions

Foaming Agent Installation & Replacement

1.The entire bottle of foaming agent (480mL) can be used multiple times. If the foaming effect is unsatisfactory, regularly check whether the agent is depleted or has become diluted.

2.For initial installation: Place the foaming agent bottle steadily on the ground. Insert both tubes into the top of the bottle. Installation is complete.

3.When replacing an empty bottle: Carefully pull out the two rubber tubes from the foam bottle. Install the new foaming agent bottle using the method described above.



Note:

1.First-time use: Due to air trapped in the tubes, the foaming liquid may not reach the foamer immediately. Activate the Foam Shield function 1–2 times before foam can appear and function normally.

2.Replace the foaming solution promptly once its color turns clear as water.

Troubleshooting Guide

Fault Condition	Cause	Solution
No foam from outlet	Foaming agent depleted	Add foaming agent solution
Poor foaming effect	Inlet water angle valve is closed	Open the inlet water angle valve
	Foaming agent has become dark/dirty	Replace foaming agent solution
Auto mode: No Foam Shield activation when seated	Foam Shield auto function not enabled	Enable the Foam Shield auto function
	Not seated correctly or exited position	Adjust seating/sensor position
Remote control cannot activate function	Remote control battery low	Replace remote control batteries

If the fault persists after checking the above, please contact the product retailer or the company's after-sales department.

Usage Instruction

Water Amount And Temperature

Due to the storage water heating mode, the water temperature will not decrease when cleaning for a long time. Although the water temperature may fluctuates, it doesn't effect the normal use.

Cleaning water will be controlled according to original setting temperature.

5 levels of water temperature
normal-34°C-36°C-38°C-40°C

Heating time depends on external water inlet temperature.

Installation with the Seat Sensor

When you are not seated and accidentally press the button, the spout will not operate due to the seat sensor. All cleaning functions will not be set when not seated.



The Seat Sensor

The seat sensor will not work if the following conditions occur:

✘ The human body does not sit on the seat ring.

Environment usage instruction:
It is recommended that there should be no obstacle within 1.5m of the toilet, otherwise it will cause the flip lid to make wrong instructions.



Fault Judgement And Maintenance

If there is a fault, some faults can be eliminated by simple operation, before the professional repair, please confirm the following matters.

Symptom	Cause	Inspection Method
Nozzle failure	The power outlet is not powered on.	Please confirm whether there is a power outage.
	The power switch is in the "Off" state.	Press the power switch, the power plug indicator lights up to start.
	The power plug is not plugged into the socket.	Please plug in the power supply.
	Electric leakage.	Please unplug the power and call a technician to repair it.
	The water inlet valve is closed.	Open inlet valve.
	The filter has impurities.	Cleaning the filter.
	The connecting water inlet pipe is blocked.	Clean the flow pipe.
	Not in the active range of the seat sensor.	Adjust seating position.
	Cleaning nozzle is blocked.	Cleaning nozzle.
	Low water pressure.	Increase the water strength, or start the air pump pressurization.
	The water supply hose freezes.	Use a cloth soaked in warm water to cover the water supply hose and water supply connection. Or raise the indoor temperature to thaw naturally.
Cleaning water temperature is not warm	The water temperature is not set at the proper temperature.	Press the water temperature button to adjust temperature.
	The inlet water temperature is too low.	Wash for a while and then observe.
The seat ring is not warm	Seat temperature is not set at proper temperature.	Press the seat temperature button to adjust the temperature.

If the fault cannot be immediately eliminated through the above confirmation, please contact the dealer who purchased the product or contact the company's after-sales service.

Remote Fault Diagnosis

Operating through the toilet side button, you can check whether the flushing function and the trial run work appropriately. (Start the cleaning and drying function after seated)



Emergency Fault Judgement

Under no water supply circumstance, put around 2.1 Gal(8L) water into a barrel and flush the bowl of ceramic.

Note: Avoid water spilling from bowl.



When the product is left unused for a long time

- Especially in winter when no one at home for a long time, please drain out the water inside the tank and the pipe to prevent freezing

To Discharge Water

1. Unplug and cut off the electricity.
2. Unscrew the hose connector off angle valve, drain the water in the pipe and reinstall.
3. Handle the remaining water in ceramic body. It is suggested to put some antifreeze into water inside the ceramic body.

Tips: Make sure to turn on water angle valve and power supply when you use the toilet again.



Note: Before water discharging, the power must be cut off!



Daily Maintenance

Main unit care and maintenance

1. Wipe the surface with a sponge or soft damp cloth or neutral detergent cloth.

2. **Note:** Do not use thinners, light gasoline, detergents, chemicals, etc. to wipe. Do not spray insecticides, aromatics, deodorants, etc.

Note: The material of the product is new plastic material, which is not discolored. Most of the discoloration phenomenon is oxidation reaction. Product contact with perfume, toilet cleaner, nail polish and other liquids, if not wiped off in time will cause product surface oxidation.

Some users may place a seat cushion on the seat ring with a heating function. Generally, the cushion and the contact surface of the seat are non-slip rubber, once heated, it is easy to cause the seat in contact with the location to discolor.

Spray nozzle maintenance and care

1. When no one is using it, press the "Rear" button on the remote or rotate the same "Rear" button on the side knob for nozzle or sprayer cleaning.

2. Clean with a toothbrush or a soft cloth. After cleaning, continuously press the "Position -" button on the remote control to adjust the spray rod to its original position.



Turn off the water source

Maintenance of filter net

1. If the impurities in tap water clog the filter, it will lead to poor water intake and affect the use of products.

2. Clean the filter regularly. Because of the difference in water quality, the cleaning cycle is different, it is recommended to clean once every 6 months.

3. Turn off the water source before cleaning the filter, then open the filter cover counterclockwise, remove the filter and rinse the dirt on the filter with water, and clean it with a toothbrush if necessary.

4. After cleaning, tighten the filter clockwise and confirm whether there is water leakage.



Counterclockwise open it

Technical Support

Name		Smart Toilet
Power		AC 110V 50Hz
Cleaning Device	Inlet Water Temperature	5°C-35°C
	Inlet Water Pressure	0.15-0.55MPa
	Warm Water Temperature	Adjustment Range: indoor temperature-40°C
	Spray Water Amount	About 0.45-0.65L/min (When water pressure is 0.2MPa)
	Rear Bidet (female-specific)	
	Spout Position	50mm—90mm
	Rear Bidet (female-specific)	
Heating Power		1520W
Safety Equipment		Flow SensoR, Water temperature sensor, Temperature switch, Thermal fuse
Rated Power		1200W (inlet water temperature is 15°C and Maximum temperature range)
Drying Device	Wind Speed	≥ 4m/s
	Temperature Adjustment	5 stages (room temperature - about 55°C)
	Heating Power	250W
	Safety Equipment	Thermal controller, Thermal fuse
Seat Heating Device	Temperature Adjustment	5 stages (room temperature-about 40°C)
	Heating Power	45W
	Safety Equipment	Thermal controller, Thermal fuse
	Open And Close Device	Seat ring and flip lid with damping cushioning device
	Safety Equipment	Leakage protector, The cover temperature sensor
Power Cord Length		1.2m
Tank Amount		4.3-4.5L

List of Materials



A Smart Toilet

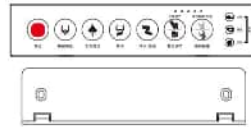

A Set Of Remote Control Components
(include remote control, bracket, double-side tape)



Woven Hose



A Water Barrier Cap (Please keep this accessory
for functional testing)



1/2" Compression Angle Stop Valve
(1 adapter)



An Installation Manual

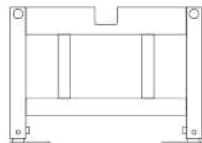

Ceramic Frame

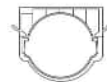

Clamp

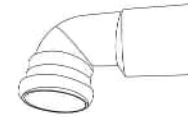

Bent-off Pipe



Direct Pipe

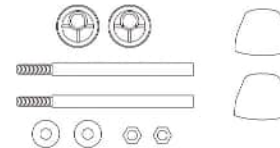

Ceramic Fixing Screws

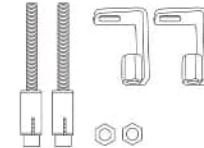

Frame Fixing Accessories



Expansion Screws



Foam Tip Adapter